

SPRINKLER HEAT ZONES:

HEAT SOURCE:	ORDINARY TEMP SPRINKLER	INTERMEDIATE TEMP SPRINKLER
SIDE OF OPEN OR RECESSED FIRE PLACE	36"	12"
FRONT OF RECESSED FIRE PLACE	60"	36"
COAL OR WOOD BURNING STOVE	42"	12"
RANGE/OVEN, HOT AIR FLUES & UNINSULATED HEAT DUCT	18"	9"
UNINSULATED HOT WATER PIPES & 250-499 WATT LIGHTS	12"	6"
SIDE OF CEILING OR WALL MOUNTED HOT AIR DIFFUSERS	24"	12"
FRONT OF WALL MOUNTED HOT AIR DIFFUSERS	36"	18"
HOT WATER HEATER, FURNACE, LIGHT FIXTURE 0-250 WATT	6"	3"

NO SPRINKLERS REQUIRED IN:
 BATHROOMS 55 SQ.FT. OR LESS IN AREA PER NFPA 13D SECTION 8.6.2
 CLOSETS 24 SQ.FT. OR LESS IN AREA PER NFPA 13D SECTION 8.6.3

PROJECT SQUARE FOOTAGES
 LOWER LEVEL = 4575 S.F.
 UPPER LEVEL = 1947 S.F.

NO.	DATE	REVISIONS	DRAWN	CHECKED

GENERAL CONTRACTOR: CARSON CITY FIRE DEPT
 AUTHORITY HAVING JURISDICTION: CARSON CITY FIRE DEPT
 ADDRESS: 777 SOUTH STEWART ST
 CITY: CARSON CITY, NV 89701
 PHONE: 775-887-2210
 CONTACT: CONTACT

ARCHITECT: FIELD INSPECTIONS:
 ADDRESS: 2.
 CITY: 3.
 PHONE: 4.

FIRE SPRINKLER NOTES:

- THE PROPOSED FIRE SPRINKLER SYSTEM IS AN ANTI-FREEZE SYSTEM AND SHALL BE DESIGNED AND INSTALLED IN ACCORDANCE WITH NFPA 13D.
- THIS SPRINKLER SYSTEM IS HYDRAULICALLY CALCULATED IN ACCORDANCE WITH NFPA 13D TO PROVIDE 0.05 GPM PER SQ. FT. OVER THE MOST REMOTE AREA.
- THE NUMBER OF DESIGN SPRINKLERS SHALL INCLUDE ALL SPRINKLERS WITHIN A COMPARTMENT UP TO A MAXIMUM OF 2 SPRINKLERS.
- ALL SPRINKLER PIPING CONCEALED ABOVE CEILING SHALL BE CPVC PIPING UNLESS OTHERWISE NOTED.
- ALL DIMENSIONS SHOWN ARE CENTER TO CENTER U.O.N.
- ALL HANGERS SHALL BE INSTALLED IN ACCORDANCE WITH NFPA 13D AND/OR NFPA 13 REQUIREMENTS.
- HOLES THROUGH SOLID STRUCTURAL MEMBERS SHALL BE PERMITTED TO SERVE AS HANGERS FOR THE SUPPORT OF SYSTEM PIPING.
- ALL SYSTEM PIPING SHALL BE TESTED FOR LEAKAGE AT NORMAL SYSTEM OPERATING PRESSURE.
- THE OWNER SHALL BE RESPONSIBLE FOR MAINTAINING A MINIMUM TEMPERATURE OF 40° FAHRENHEIT TO PROTECT FROM FREEZING. THE SECTIONS OF THE SPRINKLER SYSTEM WHERE THERE IS NO ANTI-FREEZE IN THE PIPING (UPSTREAM OF THE RISER).

SPRINKLER HEAD LEGEND

SYM	QTY	TYPE	MFG.	MODEL#	NPT	K	TEMP	FINISH	S.I.N.
⊗	44	CONCEALED	SENJU	RC-RES	1/2"	4.9	162	WHITE	SS8464
⊗	6	SEM-RECESS	SENJU	FR-RES	1/2"	4.9	205	WHITE	SS4453
⊗	1	CONCEALED	SENJU	RC-RES	1/2"	4.9	205	WHITE	SS8464
⊗	1	CONCEALED	SENJU	2H-UF	1/2"	5.6	282	WHITE	SS2531

52 TOTAL SPRINKLERS ON THIS SHEET

FIRE SPRINKLER SYMBOLS

⊗	AUTOMATIC SPRINKLER RISER	+13" ELEV. BELOW DECK OR TOS
⊕	EARTHQUAKE BRACING	+12'-9" ELEV. ABOVE FINISHED FLOOR
+	2-WAY & 4-WAY	→ CHANGE ELEVATION UP
+	PIPE HANGER & TYPE DESIGNATION	→ CHANGE ELEVATION DN
⊕	HYDRAULIC REF PT	→ INSPECTORS TEST
⊕	GRID OR THRD CAP	→ AUX DRAIN
+	GRID COUPLING	→ REVISION NOTATION
⊕	TYPICAL POINT OF CONNECTION (POC)	→ LOCAL ALARM

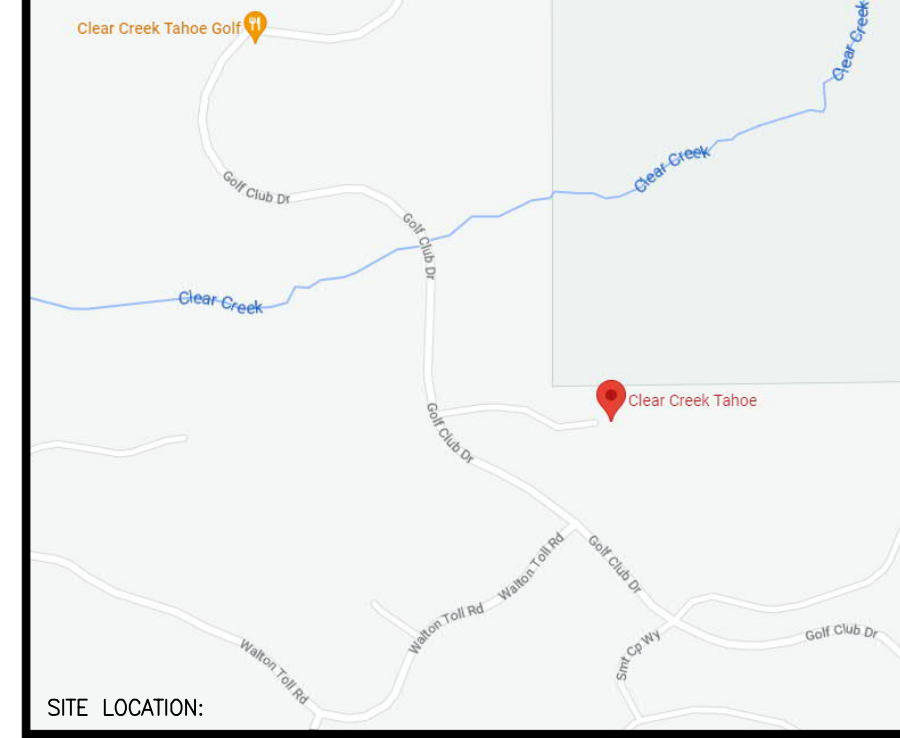

PROJECT NAME: FIRE SPRINKLER PLANS FOR
CLEAR CREEK LOT 101
 3574 KNOB POINT TRL
 CARSON CITY, NV 89705

STAMP:
 DRAWING TITLE:
FIRE SPRINKLER PLAN

SCALE: 1/8" = 1'-0"
 BORN ON DATE: 6/9/2023
 FILE:
 JOB NO.:
 DWG NO.:
FP-1
 SHEET 1 OF 1

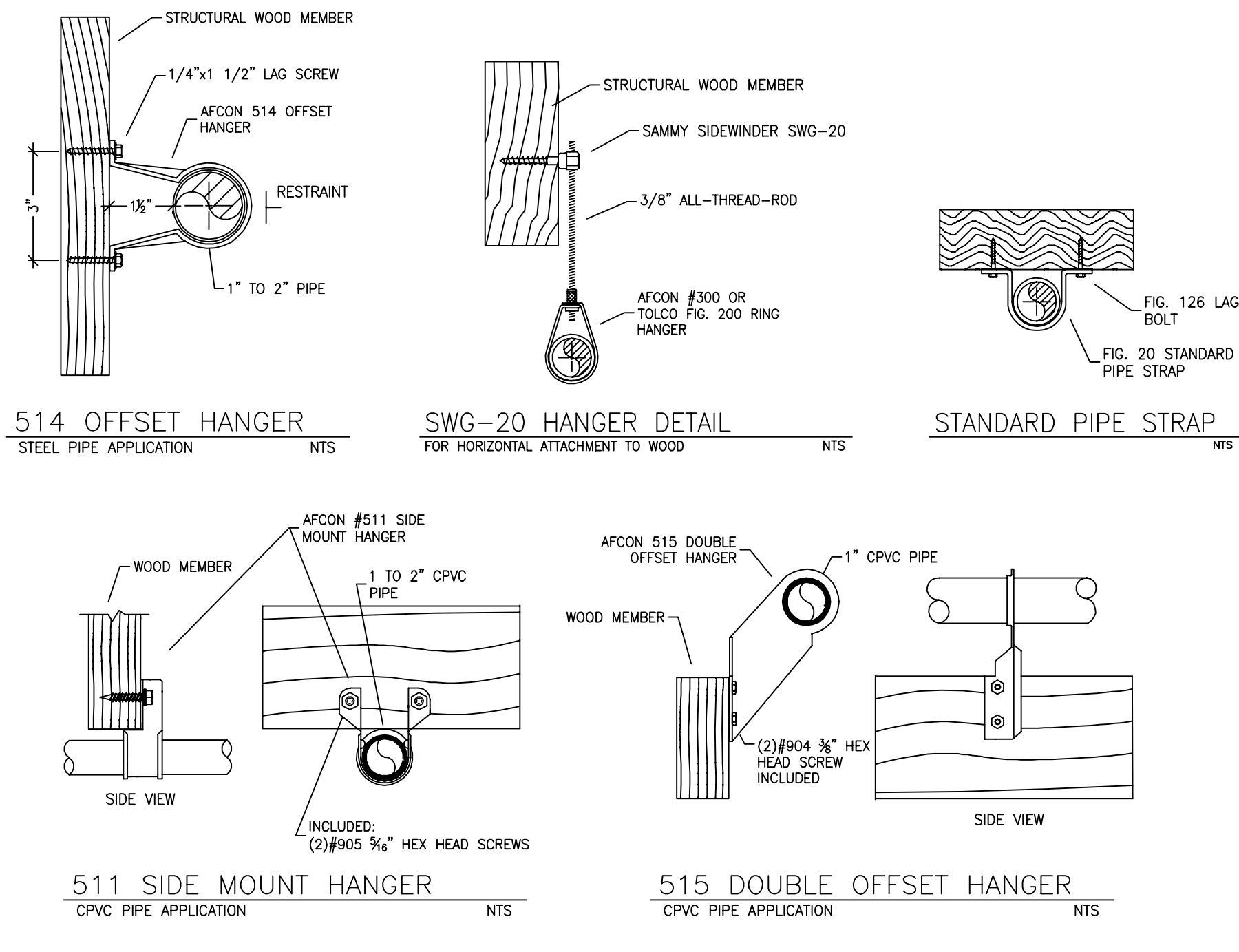

HANGER DETAILS

SPRINKLER SPACING

- A SINGLE PENDENT SPRINKLER MAY BE SPACED AT A MAXIMUM OF 18'x18' (324 SQ. FT.) OR UP TO 9' OFF A WALL (MINIMUM 8'-0" BETWEEN SPRINKLERS).
- TWO OR MORE HEADS IN A COMPARTMENT SHALL BE SPACED AT A MAXIMUM OF 18'x18' (324 SQ. FT.) OR UP TO 9' OFF A WALL (MINIMUM 8'-0" BETWEEN SPRINKLERS).
- SPRINKLERS SHALL BE MEASURED AT PERPENDICULAR ANGLES TO WALLS AND ALONG THE SLOPES OF CEILING.

Nominal Pipe Size (in.)	Nominal Pipe Size (m.)										
	1/2	3/4	1	1 1/4	1 1/2	2	2 1/2	3	4	6	8
Steel Pipe except threaded	N/A	12-0	12-0	12-0	15-0	15-0	15-0	15-0	15-0	15-0	15-0
Threaded lightweight steel pipe	N/A	12-0	12-0	15-0	15-0	15-0	15-0	N/A	N/A	N/A	N/A
Copper tube	8-0	8-0	10-0	10-0	12-0	12-0	12-0	15-0	15-0	15-0	15-0
CPVC	5-6	6-0	6-6	7-0	8-0	8-0	10-0	N/A	N/A	N/A	N/A

PIPE VOLUMES: (CPVC)

TOTAL PIPE FOOTAGE AND CAPACITY:
 1" = 511' (25.27 GAL)
 1 1/2" = 33' (2.62 GAL)

ADD 10% FOR DROPS AND PIPE SIZE DISCREPANCIES
TOTAL VOLUME: ±31.75 GALLONS

Nominal Pipe Diameter (in.)	Pipe Schedule 40	Schedule 10	CPVC
1	0.045	0.049	0.049
1 1/4	0.078	0.085	0.079
1 1/2	0.106	0.115	0.104
2	0.174	0.190	0.174
2 1/2	0.248	0.283	0.248

PROJECT SUMMARY:

PROJECT NAME: CLEAR CREEK LOT 101
 PROJECT ADDRESS: 3574 KNOB POINT TRL, CARSON CITY, NV
 APN:
 PROJECT TYPE:
 TYPE OF CONSTRUCTION:
 OCCUPANCY GROUP(S):
 OCCUPIED LEVELS:
 TOTAL SPRINKLERED AREA:
 NFPA CODE REQUIREMENT:
 NUMBER OF SYSTEMS:
 SYSTEM TYPE(S):
 TOTAL SPRINKLERS:
 SPECIAL NOTES:

NEW T.I.
 V-B
 R-3 U
 2
 6522 SQ. FT.
 NFPA 13 NFPA 13R NFPA 13D
 WET ANTI-FREEZE DRY PREACTION
 52
 SEE FIRE SPRINKLER NOTES THIS SHEET

SUBMITTAL

REMOTE AREA 1
 Hydraulically Calculated System

This system as shown on Fire Protection Plan company plot no. FP1 dated 5/31/2023 for CLEAR CREEK LOT 101 contract no. is designed to discharge at a rate of 0.05 gpm (L/min) per sq ft (m²) of floor area over a maximum area of NFPA 13D - 2 SPRINKLERS sq ft (m²) when supplied with water at the rate of 30.1 gpm (L/min) at 79.1 psi (bars) at the base of the riser. Hose stream allowance of 5 gpm (L/min) is included in the above.

Occupancy classification: LIGHT HAZARD
 Commodity classification: N/A
 Maximum storage height: N/A
 Safety factor: 6.8

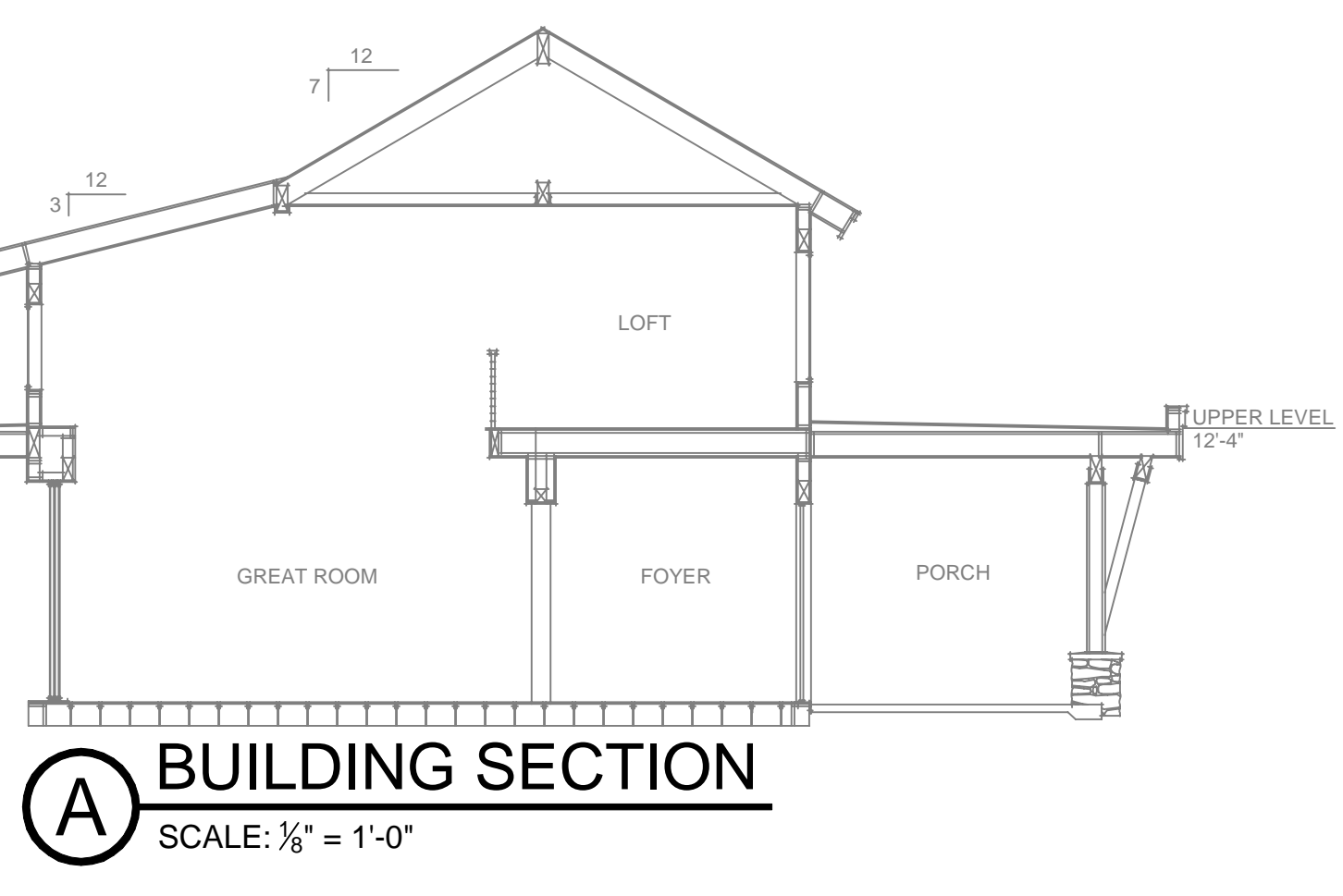

BUILDING SECTION
 SCALE: 1/8" = 1'-0"

FLOW TEST INFO:
 STATIC: 86 PSI
 RESID: 57 PSI
 FLOW: 791 GPM
 DATE: 03/03/2023

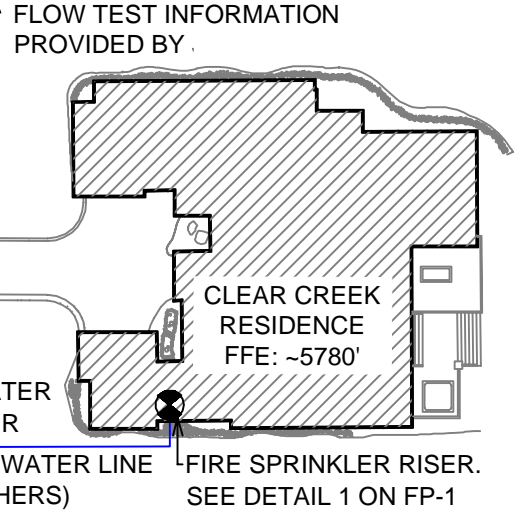

SITE PLAN
 SCALE: 1" = 50'-0"